

TUNERS / CASSETTE / DISC PLAYERS						RADIO EQ STACK
	MINI	STAN	DIN	ISO DIN	SINGLE DBL DIN	
CHASSIS H	1 1/2-2	2	2	2	3 7/8	3
CHASSIS W	7 1/8	7 1/8	7 1/8	7	7 1/8	7 1/8
CHASSIS D	4 3/4-5 1/2	5 7/8-6 11/16	5 7/8-6 11/16	5 7/8-6 11/16	5 7/8-6 11/16	5 7/8-6 11/16
NOSE H	1 1/2-1 3/4	1 1/2-1 3/4	2 1/8	1 13/16	3 3/4-4	
NOSE W	4 1/2-4 7/16	4 1/2-4 7/16	7 1/2	6 11/16	6 11/16-7 1/4	
SHAFT SP.	5 1/2-5 7/8	5 1/2-6				

IN DASH APPLICATION NOTES

	K ^S	K ^S	K ^S	K ^S	N	N
--	----------------	----------------	----------------	----------------	---	---

APPLICATION KIT MODEL:	FD136010
HARNESS ADAPTOR:	FD02
ANTENNA ADAPTOR:	

IN-DASH INSTALLATION AREA DIMENSIONS

	DEPTH	MAX DEPTH	WIDTH	HEIGHT
CAVITY	6 1/8"	6 1/8"	9 1/4"	5 1/4"
DASH OPENING	TYPE: CUSTOM OVAL *		X=10 5/8"	Y=6"
DASH MATERIAL: VINYL/PLASTIC			THICKNESS:	
FOR MAX DEPTH	<input type="checkbox"/> REMOVE REAR SUPPORT <input type="checkbox"/> MODIFY CAVITY			

AMPLIFIER/EQ MOUNTING LOCATIONS (WxHxD)

UNDER/IN DASH	UNDER SEAT	GLOVE BOX	TRUNK/CARGO
			Various

Dimensions shown are inches.
For inch/mm conversions refer to chart section.

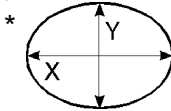

NOTE: THIS MANUAL IS BASED ON CAREFULLY DOCUMENTED RESEARCH. ABSOLUTE ACCURACY IS ATTEMPTED BUT NOT GUARANTEED. USE THIS MANUAL AS A REFERENCE GUIDE. SCOSCHE, INC. CANNOT BE RESPONSIBLE FOR INCONSISTENCIES THAT MAY OCCUR.



- B = BACK UP PLATES REQUIRED.
- C¹ = CUT TRIM/PLASTIC (STRUCTURE).
- C² = CUT STEEL.
- D = BELOW DECK ONLY.
- D¹ = LIFT PORTION OF DECK. (MAY REQUIRE STRUCTURAL REINFORCEMENT).
- D² = CUT STEEL WHEN TOP MOUNTED. DO NOT IF BELOW DECK.
- D³ = NARROW SURFACE, BELOW DECK ONLY.
- F¹ = MINIMUM MODIFICATION FILE SHAFT HOLES OR DASH OPENING.
- F² = MODIFY DASH CAVITY AND/OR PANEL.
- K = INSTALLATION KIT, SPACER OR ADAPTOR REQUIRED.
- K¹ = KIT MODIFICATIONS REQUIRED.
- K² = EXTENSION KIT RECOMMENDED.
- K³ = WHEN EQUIPPED WITH FACTORY "ELECTRONIC" RADIO.
- K⁴ = FABRICATE PANEL/BRACKETS.

UPDATED THROUGH
'98
'99
2000
2001

FORD 1997-UP ESCORT

Sedan and Wagon

REAR DECK - SEDAN

Factory Provisions: 6 x 8" Ford style
Aftermarket: 5 1/4"K, 6 1/2"K, 5 x 7", 6 x 8"
K=SA68

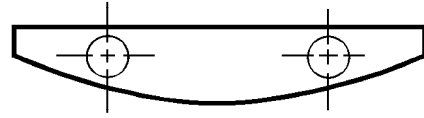

CAVITY W H D
7 3/4 x 6 x 18" To trunk floor

FRONT DOORS

Factory Provisions: 6 1/2" 3-hole
Aftermarket: 5 1/4"K, 6 1/2"

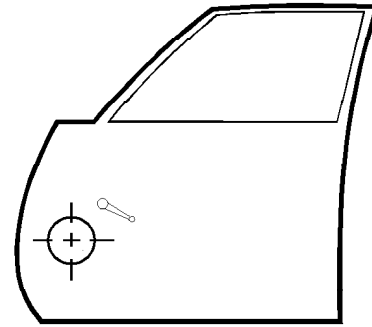

CAVITY W H D
5 3/16 x 5 3/16 x 2"

REAR SIDE SHELVES-WAGON

Factory Provisions: 5 x 7"***
Aftermarket: 5 1/4"K, 6 1/2"K, 5 x 7"

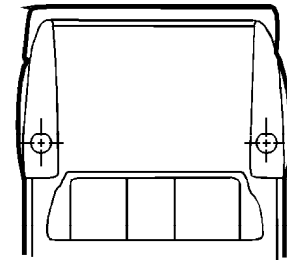

CAVITY W H D
6 x 10 x 5"

***Speaker mounts to back of grille/panel assembly

- K^S = WHEN EQUIPPED WITH STANDARD TWO SHAFT RADIO/TAPE PLAYER. FABRICATE KIT WHEN EQUIPPED WITH FLAT FACE ELECTRONIC RADIO/TAPE PLAYER.
- K^S = SCOSCHE KIT RECOMMENDED.
- N = NOT RECOMMENDED. EXTENSIVE MODIFICATION REQUIRED.
- P = PERFECT WITHOUT MODIFICATION.
- P¹ = MODIFY OR REMOVE POCKETS.
- P² = COIN POCKET LOCATION IN DASH (MAY REQUIRE TRIM KIT).
- P³ = PERFECT WHEN EQUIPPED WITH STANDARD TWO SHAFT RADIO, K WITHOUT.
- R = REAR LOAD ISOMOUNT.
- U = UNDERDASH.
- W¹ = WITH POWER WINDOWS ONLY.
- W² = WITHOUT POWER WINDOWS ONLY.

1997-UP FORD ESCORT SEDAN and WAGON



FACTORY INTEGRATED CONTROL PANEL.



FRONT DOOR 6 1/2" 3-HOLE SPEAKER PROVISION.

PRELIMINARY: DISCONNECT THE NEGATIVE BATTERY CABLE.

ANTENNA: THE FACTORY ANTENNA IS LOCATED IN THE LEFT FRONT WINDSHIELD SUPPORT PILLAR.

RADIO REMOVAL AND IN-DASH INSTALLATION:

NOTE: THE FACTORY RADIO PROVISION IS FOR A FORD CUSTOM OVAL RADIO/CLIMATE CONTROL PANEL. AN INSTALLATION KIT IS NECESSARY FOR AFTERMARKET RADIO INSTALLATIONS. WE RECOMMEND THE USE OF A SCOSCHE FD136010 INSTALLATION KIT.

1. ROTATE TEMPERATURE CONTROL TO FULL COLD (COUNTER CLOCKWISE).
2. FROM DRIVER'S (LEFT) SIDE UNDERDASH, REMOVE TEMPERATURE CONTROL CABLE FROM HEATER BOX BY RELEASING TAB, THEN PULLING STRAIGHT OFF.
3. USING SCOSCHE DT-1 DIN REMOVAL TOOLS CAREFULLY INSERT THEM INTO THE HOLES ON THE OUTSIDE EDGES OF THE RADIO/CONTROL PANEL TO RELEASE, UNPLUG ALL CONNECTORS, VACUUM LINES, AND PULL IT OUT OF THE DASH.

FRONT DOOR SPEAKER INSTALLATION:

NOTE: THE FACTORY SPEAKER PROVISION IS FOR A 6 1/2" 3-HOLE STYLE SPEAKER.

1. REMOVE (1) SCREW FROM DOOR PANEL'S ARM REST.
2. REMOVE (2) PANEL FASTENERS FROM UPPER FRONT OF DOOR PANEL.
3. REMOVE COVER CAP FROM DOOR RELEASE CUP AND EXTRACT (1) SCREW FROM THIS LOCATION.
4. PULL OUT DOOR RELEASE ASSEMBLY, TWIST COUNTER-CLOCKWISE TO RELEASE LINKAGE, AND REMOVE.
5. USING A PANEL REMOVAL TOOL, RELEASE CLIPS FROM AROUND SIDES AND BOTTOM OF PANEL, LIFT OUTWARD, UNPLUG ALL ELECTRICAL SWITCHES AND REMOVE PANEL.
6. EXTRACT (3) SCREWS HOLDING SPEAKER, UNPLUG AND REMOVE SPEAKER.

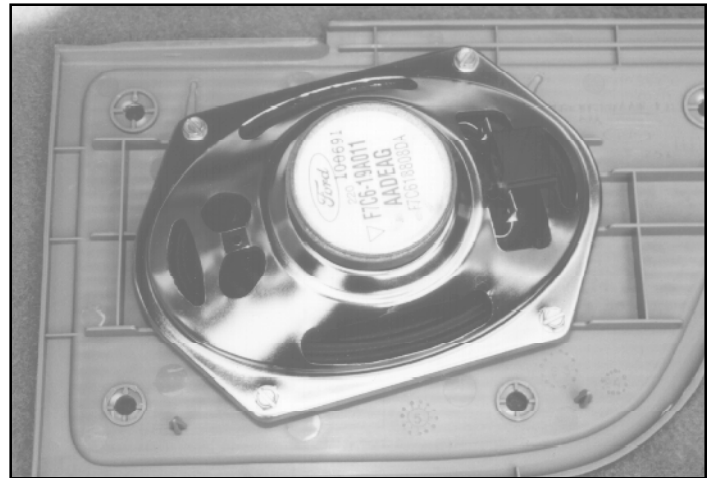

REAR SIDE SHELF - WAGON 5 X 7" SPEAKER.

REAR DECK SPEAKER INSTALLATION:

NOTE: THE FACTORY SPEAKER PROVISION IS FOR A FORD STYLE 6 X 8" SPEAKER.

1. LIFT FAR LEFT CORNER OF SEAT BOTTOM TO ACCESS (1) 12 MM NUT HOLDING BOTTOM OF REAR SEAT EDGE CUSHION. (NON-FOLDING CUSHION)
2. LIFT EDGE CUSHION UPWARD TO RELEASE AND REMOVE.
3. FOLD REAR SEAT DOWN AND REMOVE (3) FASTENERS FROM THE FRONT EDGE OF THE REAR DECK.
4. REMOVE (2) PUSH-PIN TYPE FASTENERS FROM THE 3RD BRAKE LIGHT HOUSING.
5. REMOVE (2) 10 MM BOLTS FROM 3RD BRAKE LIGHT, UNPLUG AND REMOVE.
6. SLIDE REAR DECK COVER OUT STARTING FROM SIDE WHERE THE EDGE (NON-FOLDING) CUSHION WAS REMOVED IN STEPS #1 AND #2.
7. EXTRACT (4) SCREWS HOLDING EACH SPEAKER IN, UNPLUG AND REMOVE SPEAKER.

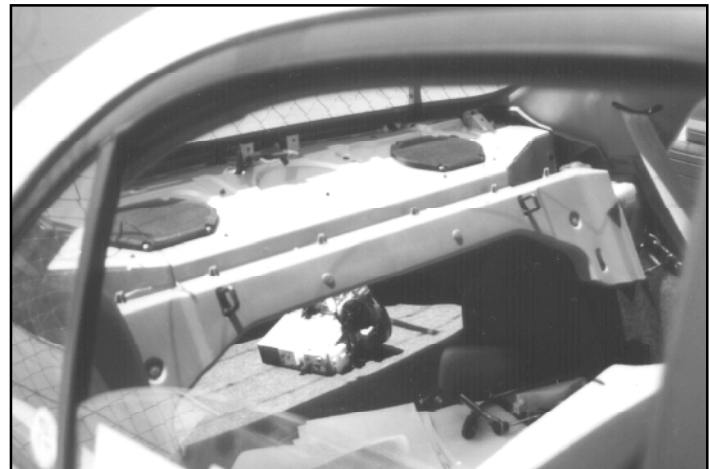

REAR DECK 6 X 8" SPEAKERS.

REAR SIDE SHELF SPEAKER INSTALLATION-WAGON:

NOTE: THE FACTORY SPEAKER PROVISION IS FOR A 5 X 7" SPEAKER.

1. EXTRACT (4) SCREWS FROM UPPER SIDE SHELF/GRILLE ASSEMBLY, LIFT UP, UNPLUG SPEAKER WIRE AND REMOVE.
2. FROM BOTTOM, EXTRACT (4) SCREWS HOLDING SPEAKER TO BACK OF GRILLE AND REMOVE SPEAKER.