

1992-UP GENERAL MOTORS INSTALLATION KIT

1996-00 Chevrolet Express Van

1996-00 GMC Savanna

RADIO REMOVAL:

- Carefully pull out on dash instrument/radio dash bezel to release spring clips, unplug connectors and remove panel.
- Compress the two plastic side radio mounting clips, slide radio out of dash, unplug connectors and remove radio.

USE THE SHADED MOUNTING TABS AND THE INDICATED BRACKETS. CUT OFF THE REMAINING TABS AND DISCARD. SEE ILLUSTRATION "C"

1997-00 Chevrolet Malibu

RADIO REMOVAL:

- Carefully pop out plastic collar around ignition key and remove.
- Carefully pop out radio trim, unplug lighter and remove.
- Extract (2) 7mm screws holding radio in, unplug all connectors and remove radio.

USE THE SHADED MOUNTING TABS AND THE INDICATED BRACKETS. CUT OFF THE REMAINING TABS AND DISCARD. SEE ILLUSTRATION "B"

1995-99 Chevrolet Monte Carlo

1995-01 Chevrolet Lumina

RADIO REMOVAL:

- Remove (4) T-15 Torx screws from the driver's lower knee bolster.
- Pull on radio dash bezel to release spring clips and remove.
- Extract (2) 7mm screws holding radio, unplug and remove radio.

USE THE SHADED MOUNTING TABS AND THE INDICATED BRACKETS. CUT OFF THE REMAINING TABS AND DISCARD. SEE ILLUSTRATION "B"

1998-01 Chevrolet S10 Pickup

1998-02 GMC Sonoma Pickup

1998-01 GMC Envoy

1998-00 Isuzu Hombre

1998-01 GMC Jimmy S-15

1998-01 Oldsmobile Bravada

RADIO REMOVAL:

- Extract the (2) screws securing the top area of the driver's side underdash cover panel.
- Pull the driver's side underdash down to access and extract (2) 7MM hex screws holding the bottom of the dash bezel.
- Extract the screw located in the top edge of the dash panel at the instrument cluster.
- Carefully pry out on the dash bezel to release the fastening clips securing the bezel to the dash and unplug headlight / misc. switches on the driver's (left) of the bezel.

USE THE SHADED MOUNTING TABS AND THE INDICATED BRACKETS. CUT OFF THE REMAINING TABS AND DISCARD. SEE ILLUSTRATION "B"

CAUTION: AT THIS POINT, TAKE CARE AROUND THE HAZARD SWITCH, BY TILTING THE WHEEL DOWN AND/OR DEPRESSING THE SWITCH SO THE PANEL WILL CLEAR. ALSO TAKE CARE TO SNAP THE PASSENGER AIR BAG SWITCH FROM THE DASH PANEL AND PUSH IT BACK THROUGH ITS OWN HOLE RATHER THAN UNPLUGGING THE SWITCH. IT IS A COSTLY REPAIR BILL IN EXCESS OF \$400.00 TO REPLACE THE HAZARD SWITCH.

- Remove the dash bezel from the vehicle.

1997-99 Chevrolet Venture

1997-99 Pontiac Montana

1997-99 Pontiac Trans Sport

RADIO REMOVAL:

- Open ashtray and extract (1) from lower right side of dash bezel.
- Open 12V socket cover and extract (1) from lower left dash bezel.
- Lift bottom of dash bezel out to allow top edge to unhook from under air vents, unplug lighter, switches and remove dash.
- Extract (2) 7mm Hex head screws holding radio in, unplug connectors, and remove radio.

USE THE SHADED MOUNTING TABS AND THE INDICATED BRACKETS. CUT OFF THE REMAINING TABS AND DISCARD. SEE ILLUSTRATION "B"

1992-99 Pontiac Bonneville

RADIO REMOVAL:

- Carefully pry out on the radio / dash trim bezel, to release fastening clips, and remove.
- Extract (3) screws holding radio, unplug, and remove radio.

USE THE SHADED MOUNTING TABS AND THE INDICATED BRACKETS. CUT OFF THE REMAINING TABS AND DISCARD. SEE ILLUSTRATION "C"

1997-03 Pontiac Grand Prix

RADIO REMOVAL:

INSTALLATION NOTE:

Because of tightened General Motors manufacturing standards, some trimming of the left and right inner-radio cavity material may be needed for proper kit clearance.

- Extract (2) panel fasteners from driver's (left) side underdash cover.
- Extract (2) 7mm hex screws from bottom edge of Driver's (left) side lower dash panel and carefully pull out on the upper panel to release (2) panel clips. Unplug and remove the dash piece.
- Carefully pull out on the complete dash/radio/instrument bezel, unplug, and unplug before removing.
- Extract (2) 7mm screws holding the factory radio, unplug connectors and antenna to remove radio.

USE THE SHADED MOUNTING TABS AND THE INDICATED BRACKETS. CUT OFF THE REMAINING TABS AND DISCARD. SEE ILLUSTRATION "C"

1994-96 Pontiac Gran Prix

RADIO REMOVAL:

- Remove ash tray.
- Extract (2) push pin style fasteners on the bottom side of the radio/dash bezel where it curves under the dash.
- Carefully pry out on the dash trim to release (2) panel clips and remove the dash piece.
- Extract (2) 7mm screws holding the factory radio, unplug connectors and antenna to remove radio.

USE THE SHADED MOUNTING TABS AND THE INDICATED BRACKETS. CUT OFF THE REMAINING TABS AND DISCARD. SEE ILLUSTRATION "C"

1995-99 Pontiac Sunfire/Convertible

RADIO REMOVAL:

- Open glovebox then remove (2) screws along the right side of the radio/heater trim bezel.
- Carefully pull out on the right side of the radio/heater trim bezel and (2) alignment pins will release on the driver's steering column panel.
- Remove radio/heater trim bezel.
- Extract (2) screws holding radio, unplug and remove.

USE THE SHADED MOUNTING TABS AND THE INDICATED BRACKETS. CUT OFF THE REMAINING TABS AND DISCARD. SEE ILLUSTRATION "C"

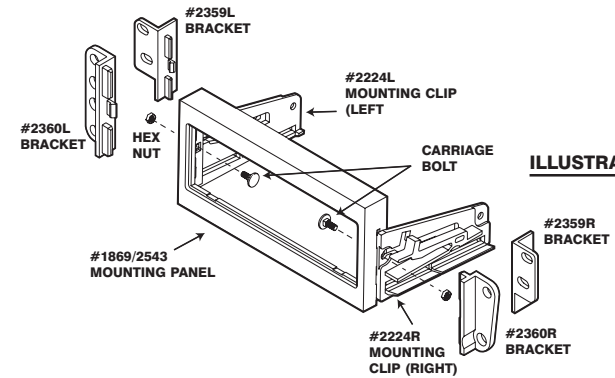

ILLUSTRATION "A"

CADILLAC

- 1999-02 ESCALADE
- 2002-02 ESCALADE EXT

CHEVROLET

- 1996-03 ASTRO
- 2001-02 AVALANCHE
- 1998-02 BLAZER S-10
- 1997-03 CAMARO
- 1994-96 CAPRICE CLASSIC
- 1995-99 CAVALIER
- 1997-03 CORVETTE
- 1995-02 CREW CAB / DUALY
- 1996-00 EXPRESS VAN
- 1994-96 IMPALA SS
- 1995-01 LUMINA
- 1997-00 MALIBU

CHEVROLET (Cont'd)

- 1995-99 MONTE CARLO
- 1995-02 PICKUP FULL SIZE
- 1998-01 PICKUP S-10
- 1995-02 SUBURBAN
- 1995-02 TAHOE
- 1997-99 VENTURE

GMC

- 1998-01 ENVOY
- 1998-01 JIMMY S-15
- 1995-02 PICKUP FULL SIZE
- 1995-02 PICKUP/CREW CAB/DUALY
- 1996-04 SAFARI
- 1996-00 SAVANNA
- 1999-02 SIERRA 1500-3500
- 1998-02 SONOMA PICKUP

GMC (Cont'd)

- 1995-02 SUBURBAN
- 1995-02 YUKON
- 1999-99 YUKON DENALI
- 2000-02 YUKON XL

ISUZU

- 1998-00 HOMBRE

OLDSMOBILE

- 1998-01 BRAVADA

PONTIAC

- 1992-99 BONNEVILLE
- 1997-03 GRAND PRIX
- 1994-96 GRAND PRIX
- 1997-99 MONTANA
- 1995-99 SUNFIRE
- 1997-99 TRANS SPORT

FACTORY WIRING CODES

For Factory Wiring Codes go to: www.scosche-cars.com

REMOVING FACTORY MOUNTING BRACKETS

If your original radio is secured to the dash with factory mounting bracket(s), use a 10mm socket wrench to remove the nut and the bracket(s) as shown.

NOTE: The factory radio may have brackets on the sides, top and/or bottom.

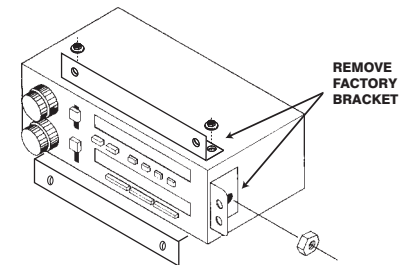

LIABILITY DISCLAIMER

This instruction booklet is based on carefully documented data and research of automobile dash disassembly, wire harness/codes and information pertaining to installation of this kit (GM1591B) in 1992-UP General Motors Vehicles. Scosche Industries, Inc. can not be held responsible for discrepancies/inconsistencies that may occur due to the automobile manufacturing changes or options, or damage that may occur in the automobile during the installation of components while using this booklet.

If you have any further questions, call

TECH HELP 1-800-621-3695 x 3

© 2004 SCOSCHE INDUSTRIES, INC.

SI 8/04 - GM1591B (3000003)

ASSEMBLY WITH FACTORY BRACKETS

TOP/BOTTOM:

Use the supplied carriage bolts and nuts to attach the factory mounting brackets directly to the kit panel as shown.

NOTE: If your bracket has small notches on it, they will have to be flattened out or filed off in order to mount the bracket to the top/bottom of the kit (see inset).

SIDES:

Attach the Factory Bracket Adapters FBA to left and right sides of the kit as shown. The FBA's locator pins should line up with the holes marked #1 on the sides of the kit panel. Be sure to insert a carriage bolt through the FBA facing outward through the square hole (see illustration). Repeat for both sides.

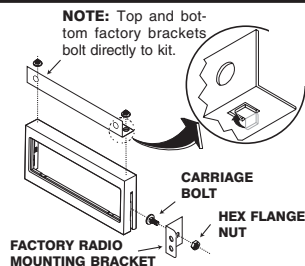

ATTACHING THE BRACKET(S)

ATTACHING THE BRACKET(S):

Remove molded-on mounting tabs (except for 1993-UP Pontiac Firebird). Snap the left and right brackets to the sides of the mounting panel as shown. Refer to the individual instructions for your particular vehicle.

CAUTION: REAR SUPPORT IS ESSENTIAL TO THE INSTALLATION'S STRUCTURAL INTEGRITY.

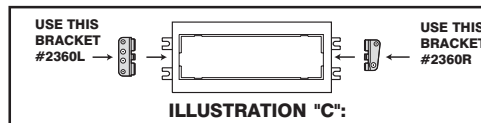
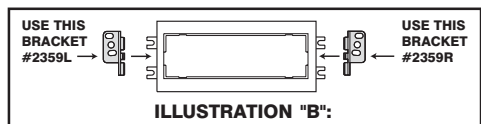

1999-02 Cadillac Escalade
2002-02 Cadillac Escalade EXT
2001-02 Chevrolet Avalanche
1995-02 Chevrolet Crew Cab / Dually
1995-02 Chevrolet / GMC Full Size Pickup
1995-02 Chevrolet / GMC Suburban

1995-02 Chevrolet Tahoe
1995-02 GMC Crew Cab / Dually Pickup
1999-02 GMC Sierra 1500-3500
1995-02 GMC Yukon
1999-99 GMC Yukon Denali
2000-02 GMC Yukon XL

ILLUSTRATION "A"

RADIO REMOVAL:

1. Engage parking brake.
2. Place key in ignition and depress brake to shift vehicle in to lowest gear. This will allow the gear shift arm to be out of the way.
3. Carefully pull out on dash instrument/radio dash bezel to release spring clips, unplug connectors and remove panel.
4. Compress the two plastic side radio mounting clips, slide radio out of dash, unplug connectors and remove radio.

NOTE: Use caution when removing the dash bezel over the hazard switch. The hazard switch may need to be pushed down as if to activate the hazard lights to allow the bezel to slide over it.

NOTE (2): It is recommended that you use the Scosche GM02 factory connector and the MDA-1 antenna adapter to eliminate the need to cut any of the factory plugs.

1996-03 Chevrolet Astro

1996-04 GMC Safari

ILLUSTRATION "A"

RADIO REMOVAL:

1. Extract (2) T-30 torx bolts, one from each side of the top console area and pop out top half of center console assembly.
2. Extract (2) 9/32" hex screws from the bottom edge of the driver's side under dash panel and (1) screw from left dash below defroster vent.
3. Carefully pry underdash panel out to release, and use caution when handling parking brake release cable.
4. Insert key into "on", adjust shifter down (low gear). Pull outward on the instrument/radio panel to release clips. Unplug switches, and remove panel.
5. Push down on side tabs securing radio, slide out of dash, unplug, and remove radio.

1998-02 Chevrolet Blazer S-10
1995-02 Chevrolet Crew Cab Dually
1995-02 GMC Crew Cab Dually

1995-02 Chevrolet / GMC Full Size Pickup
1995-02 Chevrolet / GMC Suburban

ILLUSTRATION "A"

DASH BEZEL/TUNER PACK REMOVAL:

1. Carefully remove the factory tape/EQ (or pocket) bezel by prying out along the bottom to release fastening clips. Then carefully pull down on the bezel to release the fasteners securing the top and remove the bezel.
2. Extract the two (2) screws securing the factory tape player/equalizer (when equipped).
3. Remove the dash panel under the steering column by extracting the two (2) screws securing it to the dash.
4. Locate the radio tuner pack (metal control box) under the dash above the accelerator pedal. Remove it by extracting the three (3) screws securing it to the underdash brackets.

Continued on Page 3

5. Unplug all the connectors going into the radio tuner pack and remove it from the vehicle.
6. Pull the tape player/equalizer from the dash and carefully pull the plug harness through the dash from the radio tuner pack location and remove the tape player/equalizer from the dash.
7. Locate the antenna plug and the plugs that were connected to the top of the radio tuner pack. Route them into the tape player/equalizer cavity. These are the factory power, speaker and antenna plugs that will be used for the aftermarket radio hook-ups.

NOTE: It is recommended that you use the Scosche GM02 factory connector and the MDA-1 antenna adapter to eliminate the need to cut any of the factory plugs.

OPTIONAL FACTORY RADIO DISPLAY/CONTROL UNIT REMOVAL AND POCKET REPLACEMENT:

1. Extract the (4) screws securing the instrument cluster dash bezel to the dash.
2. Pull the dash bezel from the dash, disconnect all the connectors and remove the bezel.
3. Extract the (4) screws securing the heater controls to the dash and pull it out of the dash cavity.
4. Extract the (4) screws securing the radio to the dash and pull from the cavity.
5. Route the radio leads from the tuner location as mentioned in step 4 of tape player/equalizer removal and remove the radio.
6. Install the optional pocket (Scosche part #1001518) by reversing procedures 1 through 4.

1997-03 Chevrolet Camaro

RADIO REMOVAL:

1. Carefully pry out on the radio trim bezel, to release snap clips.
2. Unplug bezel and remove.
3. Extract (2) 7mm hex head screws holding radio, unplug, and remove radio.

USE THE SHADED MOUNTING TABS AND THE INDICATED BRACKETS. CUT OFF THE REMAINING TABS AND DISCARD. SEE ILLUSTRATION "B"

1994-96 Chevrolet Caprice Classic

1994-96 Impala

RADIO REMOVAL:

1. Remove fuse panel on left side of dash.
2. Extract (1) 9/32" screw behind fuse panel.
3. Extract (2) 9/32" screws from the under dash panel on the driver's side. (Not the black wiring access panel).
4. Extract (2) 9/32" screws from below the ash tray.
5. Extract (2) 9/32" screws from the top of the instrument panel bezel.
6. Make sure the parking brake is on, then insert the key and turn to the "on" position.
7. Put the vehicle into first or low gear, and tilt the steering column adjustment all the way down and pull outward on the instrument panel bezel. There are (2) spring clips on the bottom, release and remove.
8. Extract (4) 9/32" screws holding the ash tray, remove ash tray, unplug connector for light.
9. Extract (1) 9/32" screw from upper right side of ash tray cavity.
10. Open glove box.
11. Starting from the left side of the dash, working below the steering column, pull gently outward to start releasing spring clips.
12. Work all the way across the dash piece there are about (8) spring clips total. The last one will pop out near the glove box. Remove dash.
13. Extract (2) 9/32" screws holding radio, slide radio out.
14. Unplug all connectors, antenna and remove radio.

USE THE SHADED MOUNTING TABS AND THE INDICATED BRACKETS. CUT OFF THE REMAINING TABS AND DISCARD. SEE ILLUSTRATION "B"

1995-99 Chevrolet Cavalier

RADIO REMOVAL:

1. Extract (1) screw from the front center defroster vent on top of the dashboard.
2. Using a panel removal tool carefully snap out the vent and remove it.
3. Extract (1) 7mm hex head screw from under defrost vent.
4. Using a panel removal tool remove the left dash side panel surrounding the fuse block opening and remove (1) 7mm screw from that location.
5. Using a panel removal tool release the panel at the right side of the dash and remove (1) 7mm screw behind.
6. Open glove box, extract (3) screws holding the front edge of the dash panel.
7. Extract (2) brass 7mm screws from access hole in the roof of glove box securing metal bracket.
8. Carefully release fastening clips securing the top of the dash panel above the instrument cluster, lift the panel up and away to remove.

USE THE SHADED MOUNTING TABS AND THE INDICATED BRACKETS. CUT OFF THE REMAINING TABS AND DISCARD. SEE ILLUSTRATION "B"

CAUTION!

Passenger airbag cover is attached to the dash panel and will come off with the panel.

USE EXTREME CARE WHEN WORKING AROUND THE INNER AIRBAG SKIN!

1. Extract (3) 7mm screws from the radio trim bezel and use a panel removal tool to release the snap clips around the radio and steering column.
10. Unplug bezel and remove.
11. Extract (2) screws holding radio in, unplug and remove radio.

1997-03 Chevrolet Corvette

RADIO REMOVAL:

1. Remove the front floor kick-up panel.
2. Remove the cover from the I/P electrical center.
3. Remove the RDO/CD Mini Fuse (R) #5 from the I/P electrical center.
4. Remove the console.
5. Remove the I/P accessory trim plate.
6. Remove the screws retaining the **radio** control to the I/P center support bracket.
7. Begin to remove the **radio** control from the center support bracket enough to access the connectors at rear of the radio control.
8. Disconnect the electrical/audio and coaxial cable connectors from the **radio** control.
9. Remove the **radio** control.

USE THE SHADED MOUNTING TABS AND THE INDICATED BRACKETS. CUT OFF THE REMAINING TABS AND DISCARD. SEE ILLUSTRATION "B"